

covers and cover clips – CP - CVN - F01 - F02 - F03

technical information

■ CP – covers (2 m length) CVN – covers (1 m length) F01 / F02 / F03 – cover clips

CP - covers

Supplied singly in a 2 m length, CP covers are available for 50 mm to 600 mm wide steel wire cable tray in 30 mm to 105 mm depths

CVN - covers

Supplied in packs of 3 x 1 m lengths, CVN covers are available for 50 mm to 600 mm wide steel wire cable tray in 30 mm to 150 mm depths

F01 / F02 / F03 - cover clips

Supplied in packs of 25, F01 clips are used with 30 mm deep tray; F02 clips are used with 54 mm, 105 mm and 150 mm deep tray and F03 clips are used with 80 mm deep tray. Clips can be used with both CVN and CP covers

■ Installation

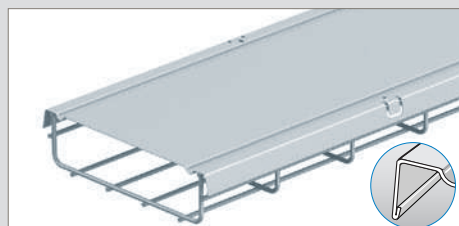

CP and CVN covers can be fitted directly with integral tabs or alternatively with optional cover clips



Use optional cover clips to secure covers

■ Assembly

Securing CP / CVN covers to steel wire cable tray

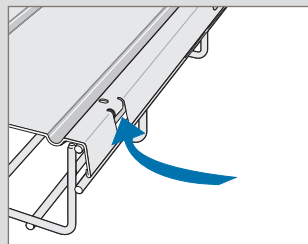

Fast assembling



Fixing without nuts and bolts

Securing F01/F02/F03 cover clips to CVN / CP covers

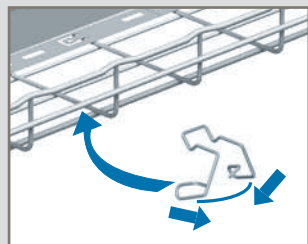

Fast assembling



Fixing without nuts and bolts

Squeeze clips at base and apply to underside of tray for F01 or side wire of tray for F02 and F03

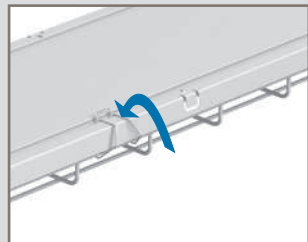

Fix the top of the clip into the groove along the edge of the lid to secure

Key:	GS Pre-galvanised	316L Stainless steel 316 L
	EZ+ Additional coating after electrogalvanisation (black)	
	GC Hot dip galvanised after manufacture	For detailed information related to finishes, refer to p. 132-133

All dimensions (mm) are nominal

→ Straight lengths : see p. 44-55

■ Dimensions and weights

CP - $\downarrow \uparrow$ 30 → 150 mm $\leftarrow \rightarrow$ 50 → 600 mm \rightleftharpoons 2 m

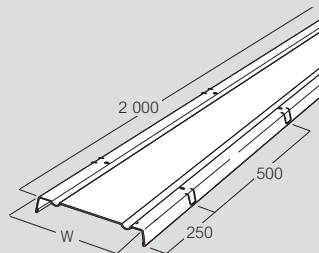

	W mm	Weight (kg)			
		GS	EZ+	GC	316L
CP50	71	1.21	1.26	1.31	1.21
CP100	121	1.68	1.76	1.82	1.68
CP150	171	2.15	2.25	2.33	2.15
CP200	221	2.62	2.75	2.84	2.62
CP300	322	3.57	3.75	3.87	3.57
CP400	425	5.68	6.78	6.56	6.05
CP450	475	6.95	—	7.40	6.90
CP500	525	6.85	8.19	7.92	7.31
CP600	625	8.03	9.59	9.28	8.57

CVN - $\downarrow \uparrow$ 30 - 150 mm $\leftarrow \rightarrow$ 50 → 600 mm \rightleftharpoons 1 m

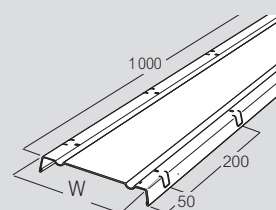

	W mm	Weight (kg) ¹		
		GS	GC	316L
CVN50	71	1.80	1.95	1.81
CVN100	121	2.52	2.73	2.52
CVN150	171	3.21	3.48	3.21
CVN200	221	3.93	4.26	3.90
CVN300	322	5.37	5.79	—
CVN400	425	8.52	9.84	—
CVN450	475	9.39	10.86	—
CVN500	525	10.29	11.88	—
CVN600	625	12.06	13.92	—

1 : Weight per pack of 3 x 1 m lengths

F01/F02/F03 - $\downarrow \uparrow$ 30 → 105 mm $\leftarrow \rightarrow$ 50 → 600 mm

F01

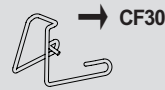

F02



F03



	Weight (kg)
	GS
F01/2/3	0.1

Please use Cat. No. when placing your order, see p. 18-19

All weights are given in Kilograms (kg) and are per unit (each)